

Atlas Copco LZL

The light, clean air motor for demanding mixing needs



Atlas Copco

Make the switch to reliable, lube-free performance.

For precise mixing needs, like chemicals, pharmaceuticals and paint, the new LZL is the ideal motor.



Flexible and suitable for the most demanding tasks, the new LZL line is ATEX certified for use in hazardous environments.

The LZL line is also designed to serve as a light power source in general applications.

With the new LZL range, Atlas Copco is proud to offer a premium solution that achieves new levels of durability, serviceability and outstanding features, including:

- Longer service life with lube-free running
- Rust protected parts on all components in contact with the mixed medium
- Double-sealed output shaft
- The shaft-seal area is vented through a single air exhaust resulting in longer seal life (Pat.)
- LZL 03/05 M are ATEX certified in temperature class T5
- Available with IEC and NEMA flanges
- Highly stable bearings eliminate need for extra mixer shaft support

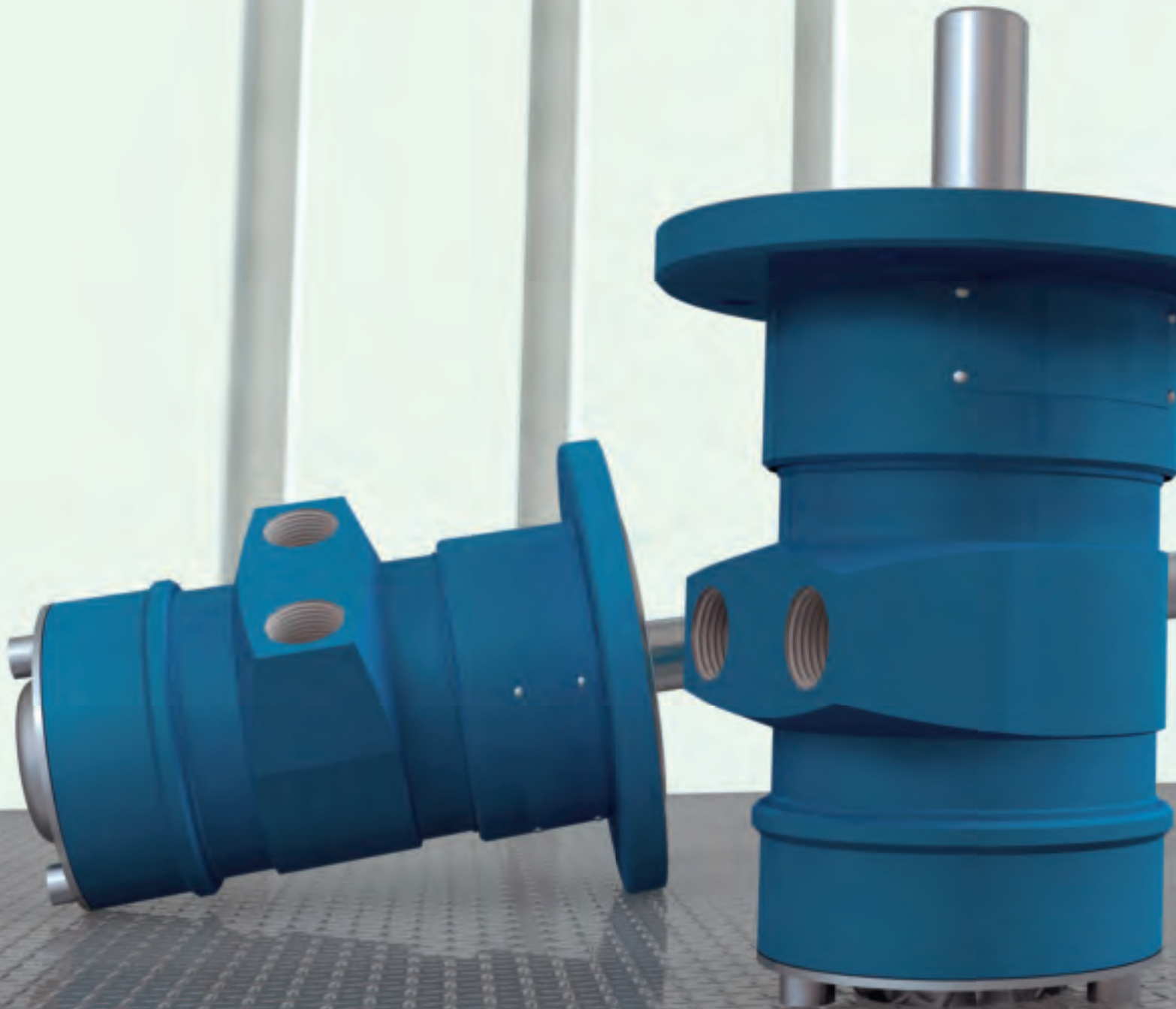



LZL is one of the lightest, most powerful and compact air motors available for today's mixing industry.



LZL is also a perfect motor in general applications.

LZL vane motors are designed to give outstanding starting and low-speed performance. This is achieved by using six vanes and optimum vane/cylinder sealing – obtained through a combination of 'vane air' and interconnecting pins.

Featuring few moving components, these motors are ruggedly constructed and offer long service life.

LZL 03 and 05 motors are available in two versions: low-speed for mixing and high-power for general applications.

Specify your LZL to match your mounting needs



Standard



IEC



NEMA



Mixer motors		Torque at half free speed		Stall torque		Free speed	Air cons. at half free speed*		Weight	
Model	Ordering No.	Nm	lbf.ft	Nm	lbf.ft	r/min	l/s	cfm	kg	lb
LZL 03 M	8411 1006 73	1,5	1,1	3,2	2,35	5800	16	34	2,9	6,4
LZL 03 M-IEC	8411 1006 92	1,5	1,1	3,2	2,35	5800	16	34	2,9	6,4
LZL 03 M-NEMA	8411 1006 81	1,5	1,1	3,2	2,35	5800	16	34	2,9	6,4
LZL 05 M	8411 1007 23	3	2,2	6	4,4	5000	23	49	3,9	8,6
LZL05 M-IEC	8411 1007 49	3	2,2	6	4,4	5000	23	49	3,9	8,6
LZL 05 M-NEMA	8411 1007 31	3	2,2	6	4,4	5000	23	49	3,9	8,6

* Note that the air consumption in a typical mixing application normally is less than 50% of the values in the table
LZL 03/05M – EX certified according to ATEX directive Ex II 2G T5 IIC D85° C

Power motors		Max Output		Speed at max output	Torque max output		Min starting torque		Free Max allowed speed	Air cons. at max output		Weight		
Model	Ordering No.	kW	hp	r/min	Nm	lbf.ft	Nm	lbf.ft	r/min	r/min	l/s	cfm	kg	lb
LZL 03 S*	8411 1006 32	1,05	1,4	5300	1,9	1,4	2,8	2,05	11000		29	61	2,9	6,4
LZL 03 S-IEC*	8411 1007 15	1,05	1,4	5300	1,9	1,4	2,8	2,05	11000		29	61	2,9	6,4
LZL 03 S-NEMA*	8411 1007 07	1,05	1,4	5300	1,9	1,4	2,8	2,05	11000		29	61	2,9	6,4
Unrestricted**		1,7	2,5	7500	2,2	1,6	3,0	2,2		11000	45	95	2,9	6,4
LZL 05 S*	8411 1007 56	1,3	1,7	4200	3	2,2	4,8	3,5	9000		37	78	3,9	8,6
LZL 05 S-IEC*	8411 1007 72	1,3	1,7	4200	3	2,2	4,8	3,5	9000		37	78	3,9	8,6
LZL 05 S-NEMA*	8411 1007 64	1,3	1,7	4200	3	2,2	4,8	3,5	9000		37	78	3,9	8,6
Unrestricted**		1,7	2,3	5400	3	2,2	4,8	3,5		9200	50	106	3,9	8,6

* Need lubrication ** Motor without restrictor plates in the air in- and outlet

LZL 03/05S- Can be Ex certified according to the ATEX directive Ex II 2G T2 IIC D240° C. Please use ordering nr 9834 1109 00 book as one delivery together with the motor
Unrestricted motors cannot be Ex certified

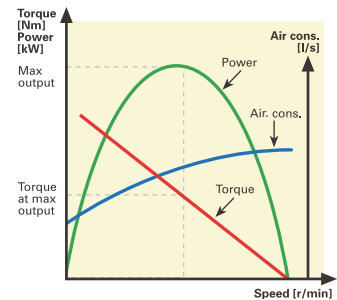
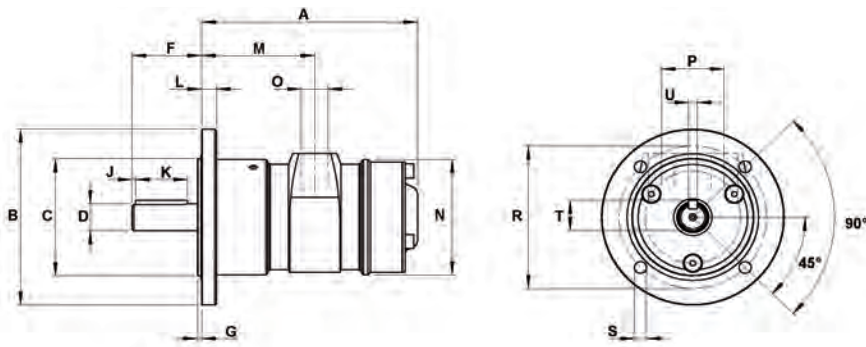
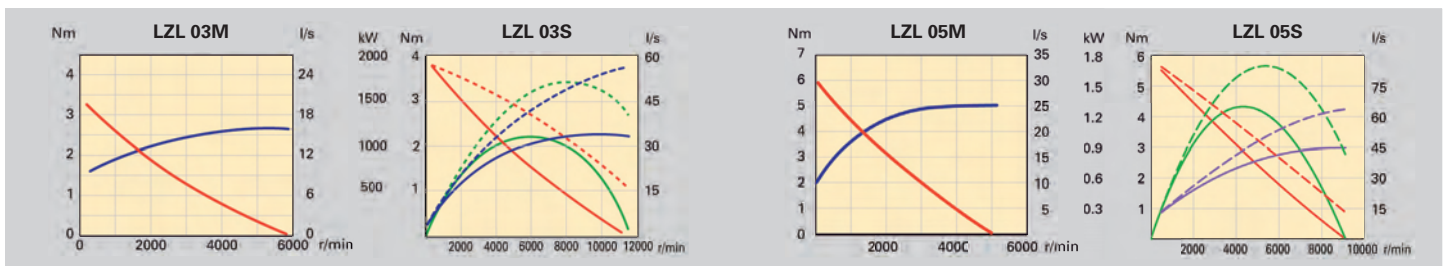

Model	A	B	C	D	F	G	J	K	L	M	N	O	P	R	S	T	U
LZL 03 M/S [mm]	124	∅105	∅70 j6	∅16 j6	40	2,5	2	30	8,5	65	∅69	G 3/8"	36	∅85	∅7	18	5 h9
IEC [mm]	124	∅160	∅110 j6	∅14 j6	30	3,5	2	20	10	65	∅69	G 3/8"	36	∅130	∅10	16	5 h9
NEMA [mm]	124	∅165,1	∅114,3	∅15,875	51,5	3	1,7	31,75	10	65	∅69	G 3/8"	36	∅149,4	3/8"-16 UNC	17,95	4,75
NEMA [inch]	4,88	∅6,5	∅4,5	∅0,625	2,03	0,12	0,07	1,25	0,39	2,56	∅2,72	G 3/8"	1,42	∅5,882	3/8"-16 UNC	0,706	0,187
LZL 05 S [mm]	153	∅105	∅70 j6	∅18 j6	40	2,5	3	30	8,5	81	∅76	G 1/2"	44	∅85	∅7	20,5	6 h9
LZL 05 M [mm]	153	∅105	∅70 j6	∅16 j6	40	2,5	2	30	8,5	81	∅76	G 1/2"	44	∅85	∅7	18	5 h9
IEC [mm]	153	∅160	∅110 j6	∅14 j6	30	3,5	2	20	10	81	∅76	G 1/2"	44	∅130	∅10	16	5 h9
NEMA [mm]	153	∅165,1	∅114,3	∅15,875	51,5	3	1,7	31,75	10	81	∅76	G 1/2"	44	∅149,4	3/8"-16 UNC	17,95	4,75
NEMA [inch]	6,02	∅6,5	∅4,5	∅0,625	2,03	0,12	0,07	1,25	0,39	3,19	∅3	G 1/2"	1,73	∅5,882	3/8"-16 UNC	0,706	0,187